

- ① Plywood Deck
- ② Equus/De Boer DuO Primer
- ③ Equus/De Boer Vapour Barrier
- ④ Equus PIR Thermal Insulation Board
- ⑤ Equus/De Boer Basesheet
- ⑥ Equus/De Boer Capsheet DuO HT 4 Slates/F C180 FireCare
- ⑦ Timber Plinth
- ⑧ Monkey Toe Roof Profile Fixing with Neoprene Washer
- ⑨ Equus/De Boer Capsheet, as separate piece over Timber Plinth

## STEP 2: Fixing of the Monkey Toe Roof Profile

### STEP 1: Fixing of the Timber Plinth

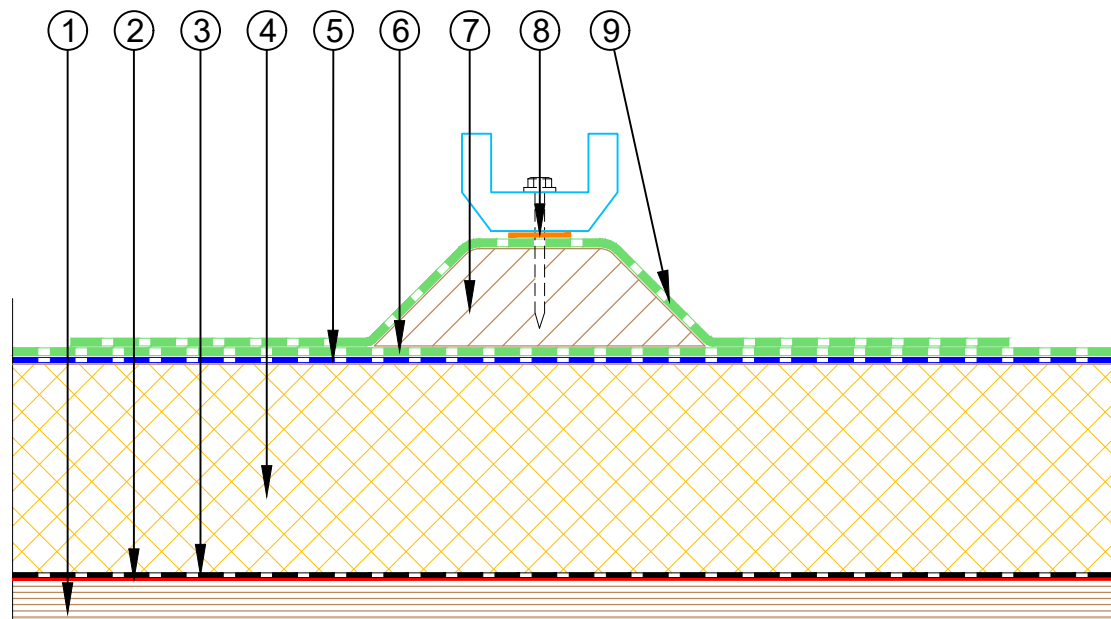
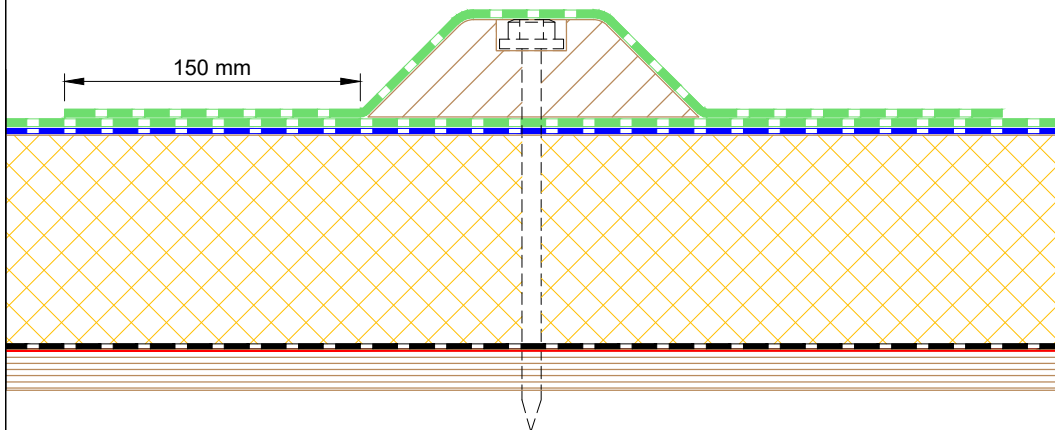

E-mail : [admin@equus.co.nz](mailto:admin@equus.co.nz)  
Web : [www.equus.co.nz](http://www.equus.co.nz)

**DuOtherm Warm Roof on Plywood  
Monkey Toe Walkway Fixing Detail**

Equus/De Boer Waterproof Membrane Details are specially drawn for use by Local Authorities, Building Contractors, Equus Applicators, Architects and design professionals. All details are drawn to assist in the development of project specific details. Details may be modified where necessary to accommodate job specific requirements but must be approved by Equus Industries Ltd. All components must be supplied by Equus Industries Ltd. Equus Industries Ltd. reserves the right to alter or upgrade details at any time without prior notice.

Drawing No:	<b>DBDTP-D12</b>
Scale:	1:4 @ A4
Drawn by:	NKT
Date:	30/10/2017



**de boer**  
waterproofing solutions  
E-mail : [info@deboer.be](mailto:info@deboer.be)  
Web : [www.deboer.be](http://www.deboer.be)