

- ① Concrete Flat Roof Slab
- ② Equus/De Boer DuO Primer
- ③ Equus Vapour Barrier
- ④ Equus PIR Thermal Insulation Board
- ⑤ Equus/De Boer Basesheet
- ⑥ Equus/De Boer Capsheet DuO HT 4 Slates/F C180 FireCare
- ⑦ Timber Plinth, glued to Capsheet
- ⑧ Clip Ring Fixing with Neoprene Washer into Timber Plinth, but not through Capsheet underneath
- ⑨ Metal Framing Fixing with Neoprene Washer into Timber Plinth, but not through Capsheet underneath
- ⑩ Equus/De Boer Capsheet, as separate piece over Timber Plinth

A. Clip Ring

B. Metal Framing

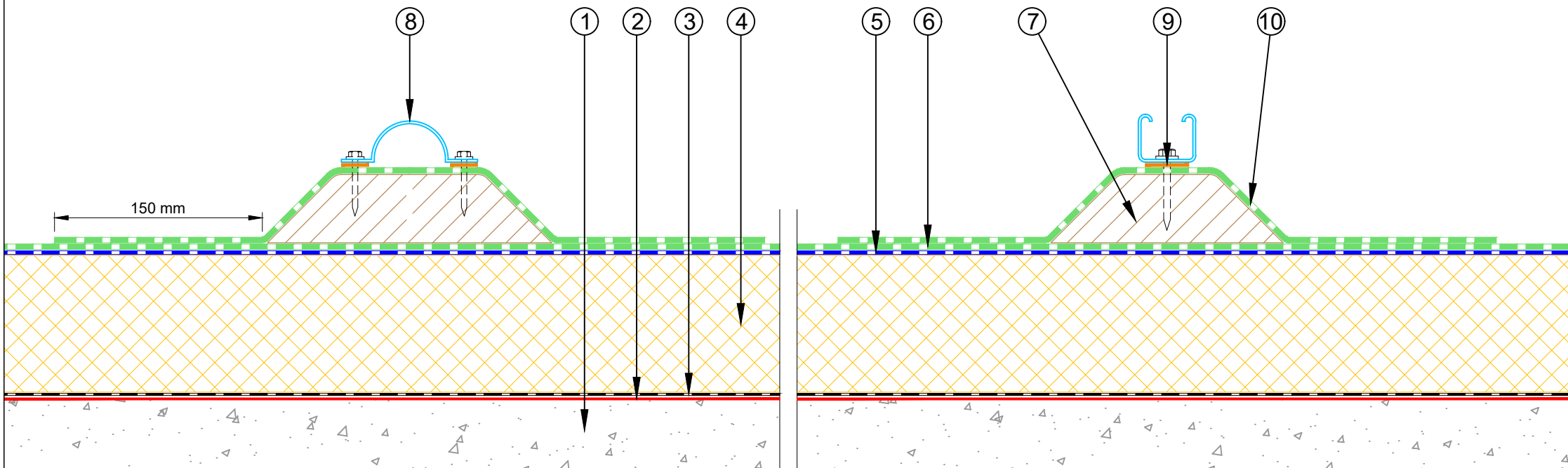

equus
 E-mail : admin@equus.co.nz
 Web : www.equus.co.nz

**DuOtherm Warm Roof on Concrete
 Cable Tray Support Fixing Detail**

Equus/De Boer Waterproof Membrane Details are specially drawn for use by Local Authorities, Building Contractors, Equus Applicators, Architects and design professionals. All details are drawn to assist in the development of project specific details. Details may be modified where necessary to accommodate job specific requirements but must be approved by Equus Industries Ltd. All components must be supplied by Equus Industries Ltd. Equus Industries Ltd. reserves the right to alter or upgrade details at any time without prior notice.

Drawing No:	DBDTC-D13
Scale:	1:4 @ A4
Drawn by:	NKT
Date:	06/10/2017



de boer
 waterproofing solutions
 E-mail : info@deboer.be
 Web : www.deboer.be