

- ① Plywood Deck
- ② Equus/De Boer DuO Primer
- ③ Equus/De Boer Basesheet
- ④ Equus/De Boer Capsheet DuO HT 4 Slates/F C180 FireCare
- ⑤ Equus/De Boer Basesheet, dressed to Parapet as separate piece
- ⑥ Equus/De Boer Capsheet, dressed to Parapet as separate piece
- ⑦ Angle Fillet
- ⑧ Cap Flashing by others

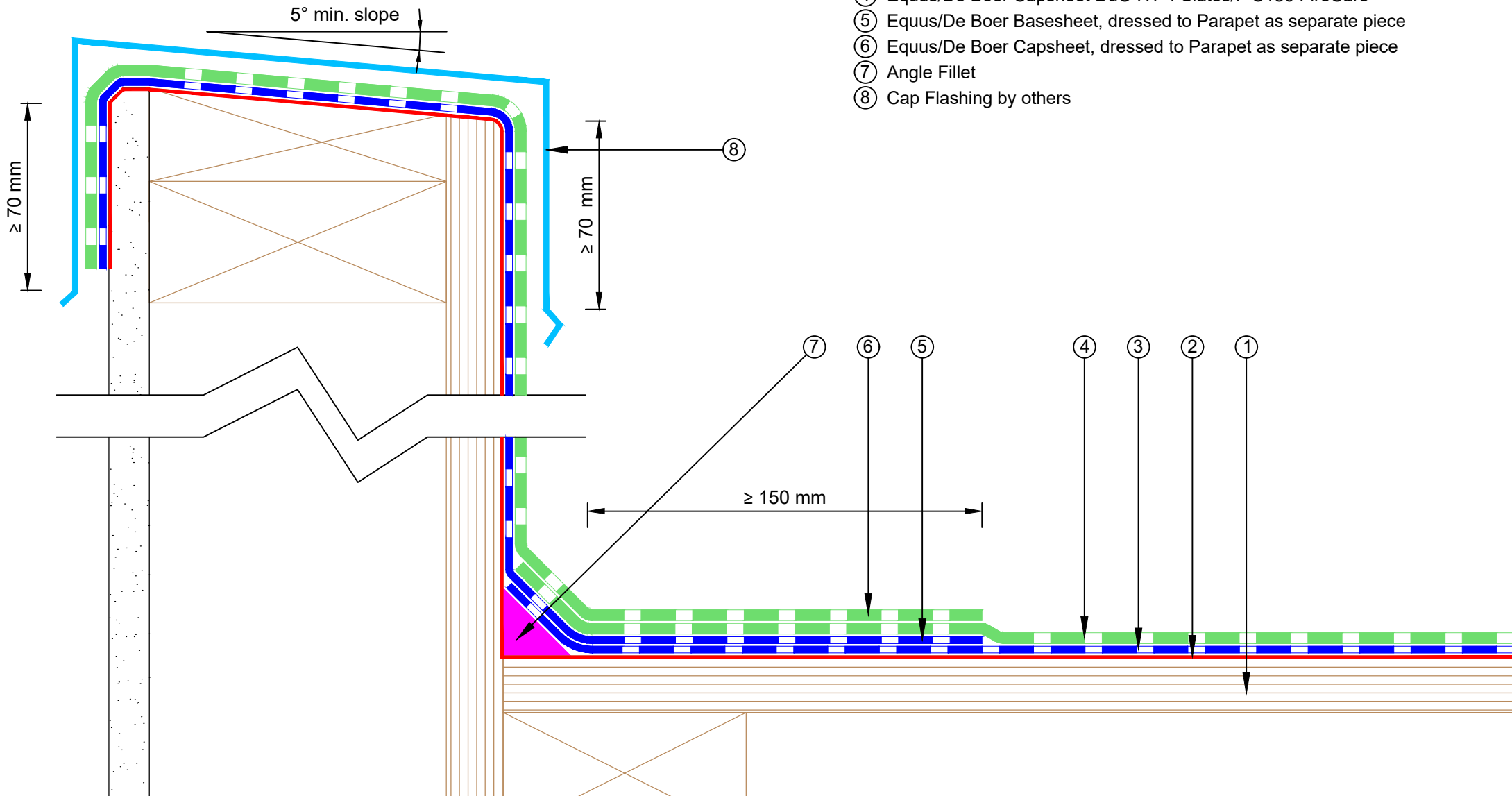

equus
 E-mail : admin@equus.co.nz
 Web : www.equus.co.nz

**De Boer DuO Cold Roof on Plywood
 Parapet Detail**

Equus/De Boer Waterproof Membrane Details are specially drawn for use by Local Authorities, Building Contractors, Equus Applicators, Architects and design professionals. All details are drawn to assist in the development of project specific details. Details may be modified where necessary to accommodate job specific requirements but must be approved by Equus Industries Ltd. All components must be supplied by Equus Industries Ltd. Equus Industries Ltd. reserves the right to alter or upgrade details at any time without prior notice.

Drawing No:	DBCRCP-D1
Scale:	1:2 @ A4
Drawn by:	NKT
Date:	04/10/2017



de boer
 waterproofing solutions
 E-mail : info@deboer.be
 Web : www.deboer.be