

- ① Concrete Roof Slab laid to Fall
- ② Equus/De Boer DuO Primer
- ③ Equus/De Boer Basesheet
- ④ Equus/De Boer Capsheet DuO HT 4 Slates/F C180 FireCare
- ⑤ Equus/De Boer Capsheet as separate piece over Batten
- ⑥ Equus Roof Cover Board
- ⑦ Roof Equipment
- ⑧ EPDM Washer under Screwhead
- ⑨ Timber Roof Batten

STEP 2: Fixing of the Equipment

STEP 1: Fixing of the batten

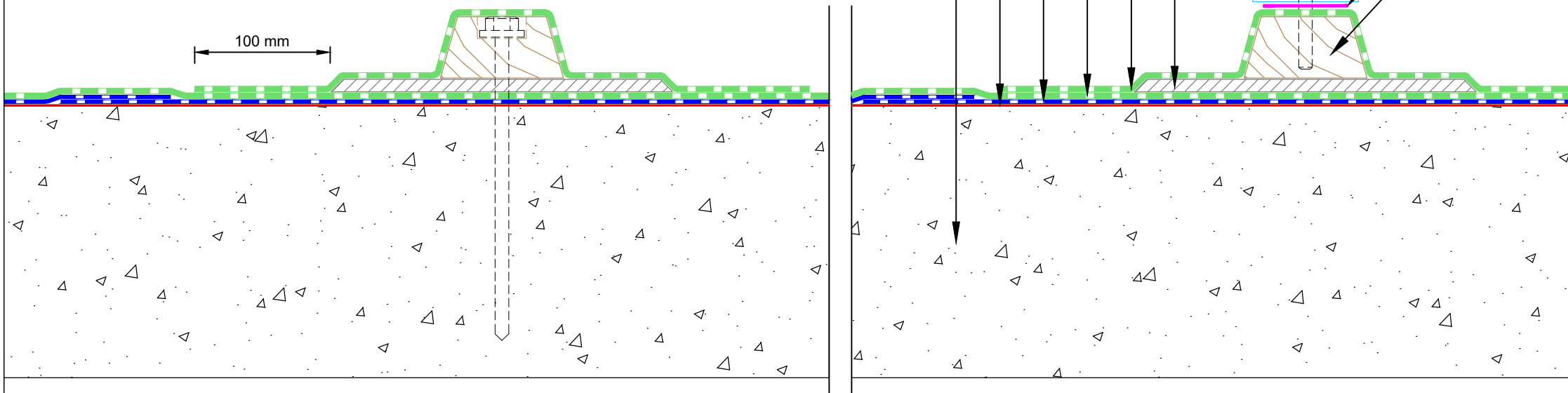

equus
E-mail : admin@equus.co.nz
Web : www.equus.co.nz

De Boer DuO Cold Roof on Concrete Roof Equipment Support Batten 2 steps detail

Equus/De Boer Waterproof Membrane Details are specially drawn for use by Local Authorities, Building Contractors, Equus Applicators, Architects and design professionals. All details are drawn to assist in the development of project specific details. Details may be modified where necessary to accommodate job specific requirements but must be approved by Equus Industries Ltd. All components must be supplied by Equus Industries Ltd. Equus Industries Ltd. reserves the right to alter or upgrade details at any time without prior notice.

Drawing No:	DBCRC-D7
Scale:	1:4 @ A4
Drawn by:	NKT
Date:	11/10/2017



de boer
waterproofing solutions
E-mail : info@deboer.be
Web : www.deboer.be