

**NOTE:**  
 Fixings through the metal flashing to be individually sealed with an approved sealant compatible with the membrane, and the type of flashing and fixing used.

VERGE DETAIL

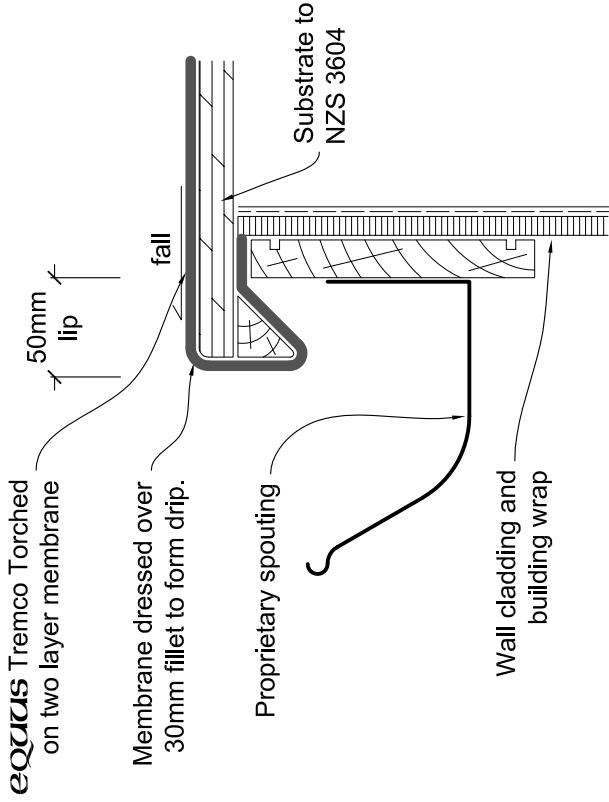

EAVES DETAIL

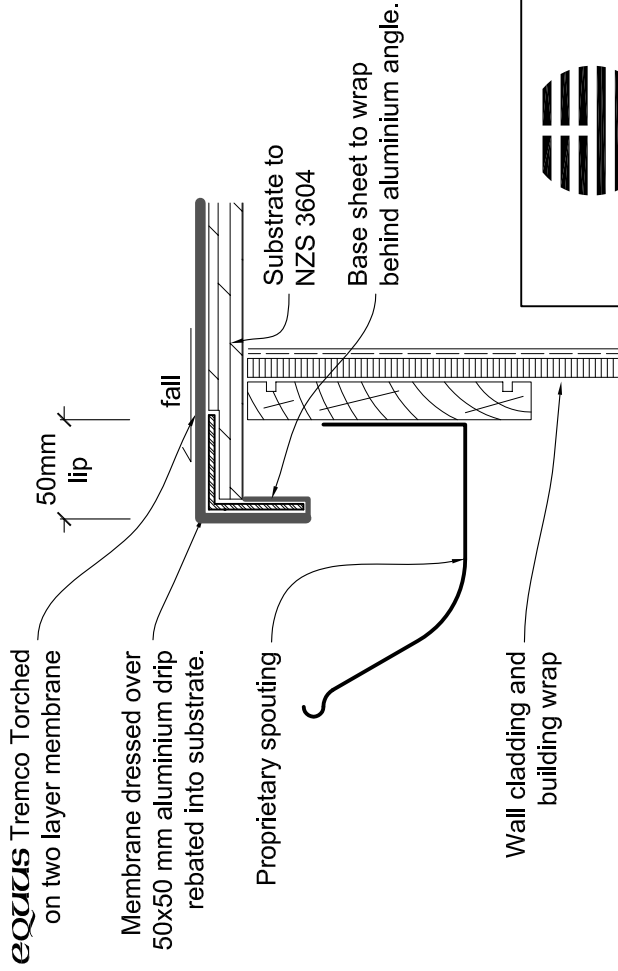

ALTERNATIVE EAVES DETAIL

**NOTE:**

This drawing is to be read in conjunction with the New Zealand building code, and NZS 3604 to determine structural framing and substrate dimensions, materials and treatment, and also minimum falls, overlapping and spouting size.

<b>Verge and Eaves Details</b>	Drawing No: <b>TP3.1.1</b>
	Cad ref:
	Drawn by: <b>NLH</b>
	Date: <b>31/01/05</b>



EQUUS Tremco Torched on Details are specifically drawn for use by Local Authorities, Building Contractors, Equus Applicators, Architects and design Professionals. All details are drawn to assist developing project specific details. However they can be modified where necessary to accommodate job specific requirements, but must be approved by Equus Industries Limited. All components must be supplied by Equus Industries Ltd. We reserve the right to alter or update Details at any time without prior notice.