

eQUUS Tremco torched on two layer membrane fully bonded except over 300mm underflashing.

300mm **eQUUS** Aquasel 1.1 self adhesive strip fully bonded to both sides of joint.

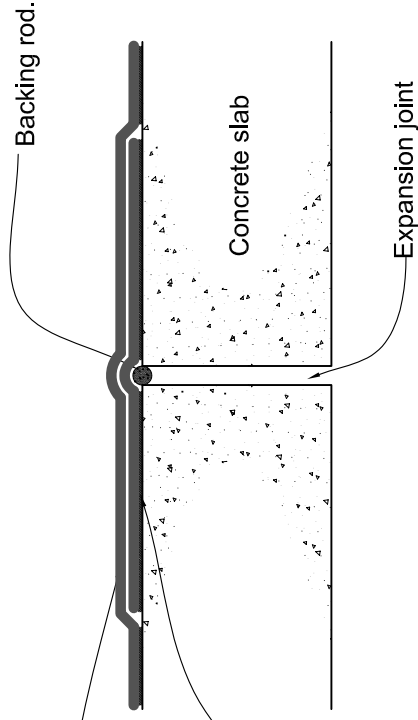

NOTE:

This drawing is to be read in conjunction with the New Zealand building code, NZS 4210, NZS 4229, and NZS 4230 to determine substrate dimensions, materials, and treatment, and also minimum falls.

| | |
|-------------|----------|
| Drawing No: | TC5.2.1 |
| Cad ref: | |
| Drawn by: | NLH |
| Date: | 31/01/05 |

Horizontal Expansion Joint

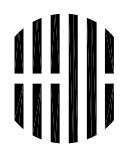

eQUUS
WATERTIGHT TECHNOLOGY

Equus Tremco Torched on Details are specifically drawn for use by Local Authorities, Building Contractors, Equus Applicators, Architects and design Professionals. All details are drawn to assist developing project specific details. However they can be modified where necessary to accommodate job specific requirements, but must be approved by Equus Industries Limited. All components must be supplied by Equus Industries Ltd. We reserve the right to alter or update Details at any time without prior notice.