

Exposed Portion of Wall Should Have Above Grade Waterproofing To Prevent Water From Entering Through Wall Face or Construction Joints and Traveling Down Behind Paraseal.

Continuous Paraterm Bar Nailed Every 8" O.C. Finish Grade Should Occur at or Below Paraseal Waterproofing.

Temporary Tape at all Vertical Seams Down to 18" Below Finish Grade.

Paraseal Sheet Lowered into Place With Bentonite Side Against Substrate. Cover Top 4" of Paraseal Starter Strip.

NOTE: This detail and installation technique to be used only when space will not allow workers in the backfill area. Normal block walls to be waterproofed the same as concrete c.i.p.

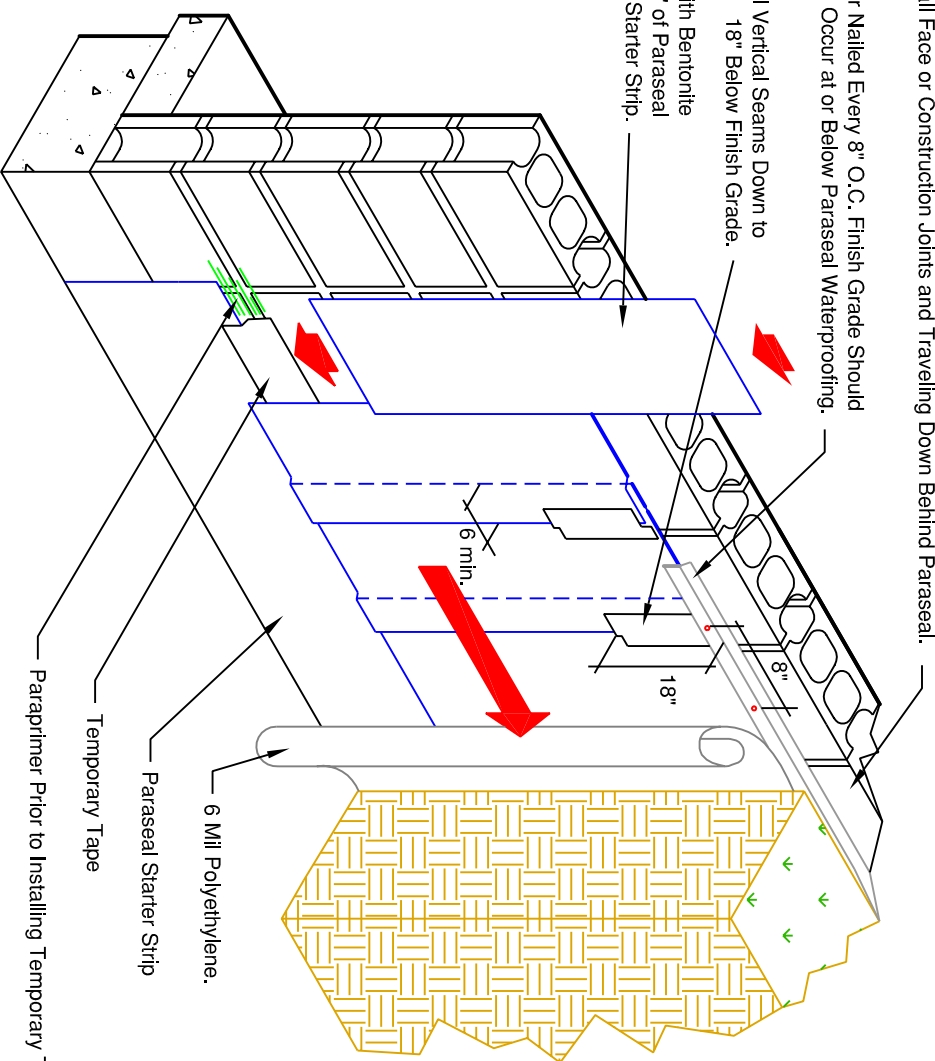

Paraseal Installation: Close Clearance at Masonry Wall

No.	Date	Description	By
TREMCO 3735 Green Road Beachwood, Ohio 44122 216-292-5000			
Project: Backfilled Walls			
Drawn by: J. Davis	Scale: Not To Scale	Date: 04/27/01	Drawing/Index No. BFW-03